

State of South Carolina

(268)

Pursuant to a warrant from John Thomas Esq. Commissioner of Locations dated the 29th day of July 1784 I have admeasured and laid out unto Charles Hester a Tract of land containing 152 acres, situate in Ninety six District East of the Old Boundary on both sides of Abbotts Creek of Broad River, bounding on all sides on Vacant Land & hath such form and marks as follow

Surveyed the 17th day of Sept. 1784

Recorded the 28th Dec. 1784

Geo. Salmon

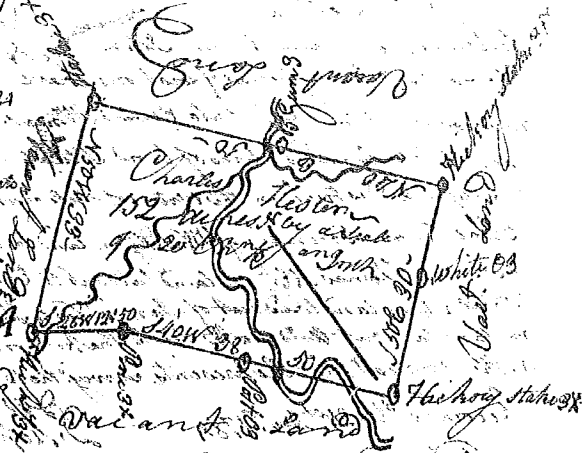

State of S. Carolina

Pursuant to a warrant from John Thomas Esq. Commissioner of Locations dated the 29th July 1784. I have admeasured & laid out unto Charles Hester a Tract of land containing One Hundred Fifty Acres situate in Ninety six District East of the Old Boundary on both sides of the Broad River fork of Thickety Creek Waters of Broad River bounding on all sides on Vacant Land & hath such form & marks as the annexed plat represents

Surveyed the 6th day of Sept. 1784

Recorded the 28th Dec. 1784

George Salmon

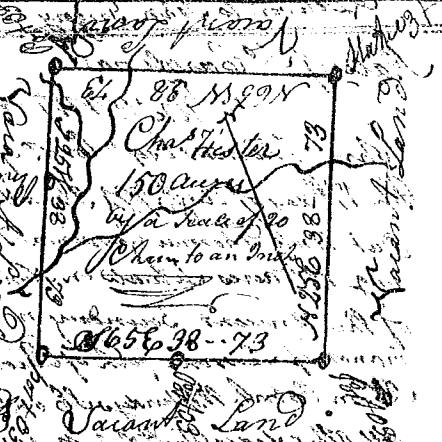

State of South Carolina

Pursuant to a warrant from John Thomas Esq. Commissioner of Locations dated the 28th day of July 1784. I have admeasured and laid out unto Lewis Ledbetter a Tract of Land containing One Hundred Acres situate in Ninety six District East of the Old Boundary on both sides of Abbotts Creek of Broad River bounding N. E. on Nicolas Currys land and all other sides on Vacant Land and hath such form & marks as the annexed plat represents

Surveyed the 24th Sept. 1784

Recorded the 28th Dec. 1784

Geo. Salmon

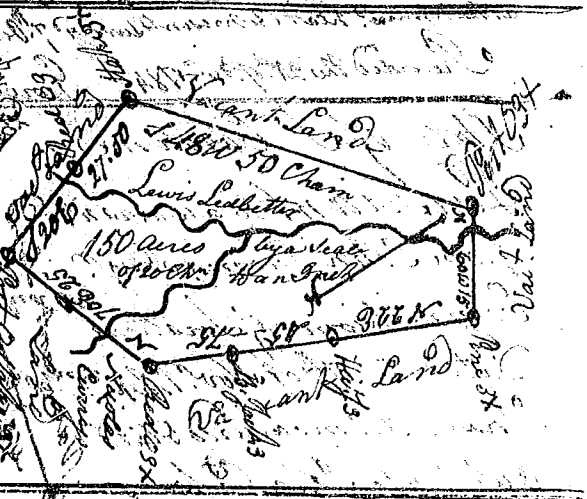

State of S. Carolina

Pursuant to a warrant from John Thomas Esq. Commissioner of Locations dated the 17th day of August 1784. I have admeasured & laid out unto Charles Patrick a Tract of land containing One Hundred acres situate in Ninety six District East of the Old Boundary on both sides of Abbotts Creek of Broad River bounding N. E. on Nicolas Currys land and all other sides on Vacant Land & hath such form & marks as the above plat represents

Surveyed the 20th day of Sept. 1784

Recorded the 28th Dec. 1784



George Salmon